

As approved by The Rover Co. Ltd.
for use with the

Adrolic

**3 POINT
LINKAGE**

**LAND-
ROVER**

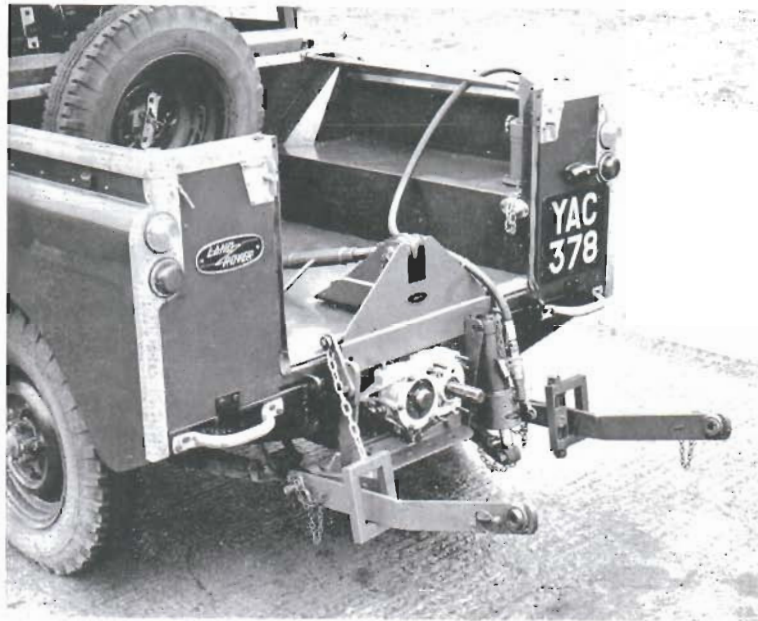

The introduction of a Hydraulic Lift and 3 Point Linkage which can take class 1 or 2 implements opens up a wide variety of new uses for the Land Rover.

This new unit was specially designed and developed so that the Land Rover can be used to supplement tractor duties and still retain the features that have made it a popular favourite all over the world. The Lift unit has a maximum lifting capacity of 5 cwts., and should only be used with Land Rover approved implements. The actual linkage equipment can be easily and quickly fitted—only six fixing bolts required. The pump mounting is also a very simple arrangement.

When not in use the Top Link, Chains, Drag Links and Cylinder can be removed in a few moments, and the complete unit can be taken off by withdrawing four bolts.

Patentees and Manufacturers:

ADROLIC ENGINEERING COMPANY LIMITED

CLOBER WORKS

MILNGAVIE

Phones and Grams : Milngavie 1063/4

SCOTLAND

ADROLIC 3 POINT LINKAGE OPENS UP A WIDE



CEMENT MIXER
IN RAISED POSITION



FERTILIZER DISTRIBUTION IN TRAVELLING POSITION

★



BRACKEN AND SCRUB CLEARER



6in. POST HOLE DIGGER



EARTH SCOOP OR LOADER

FIELD OF NEW USES FOR THE LAND ROVER



ALL-WORK SAWBENCH IN TRAVELLING POSITION



SPRING TINE HARROW



5ft. MOWER IN RAISED POSITION

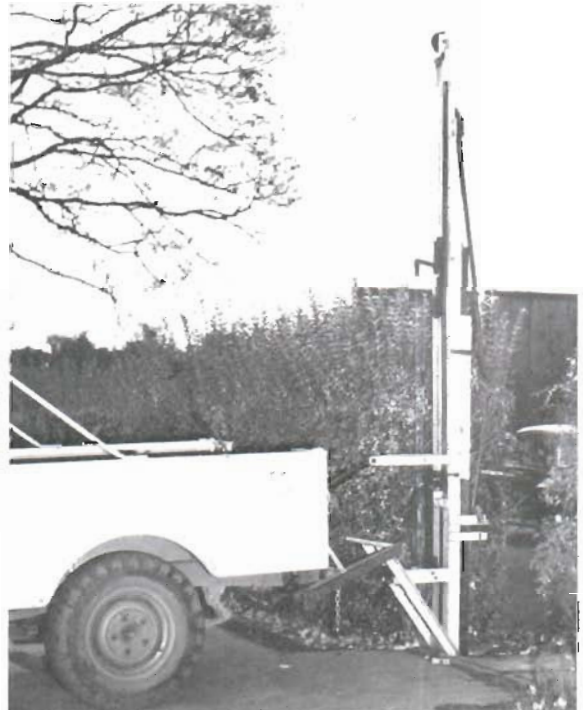

FENCE POST PILEDRIVER
WITH ADROLIC 3-POINT LINKAGE



TWO-FURROW PLOUGH IN RAISED POSITION

FITTING INSTRUCTIONS SENT WITH
EACH UNIT

SPECIFICATION DETAILS OF THE ADROLIC 3 POINT LINKAGE

HAND PUMP—P.7 1½" bore x 1¼" stroke.
Delivery—1.2 cub. ins. per cycle. Relief pressure 1,500 p.s.i.

RESERVOIR—T.12 Flange base fitting, Rotatable mounting.
Capacity 45 cub. ins.

HYDRAULIC CYLINDER—R.67 2¼" bore x 4" stroke, S/A Pull. Gravity drop.

Maximum lifting capacity at drag link outer ends—5 cwts.
In accordance with approved Land Rover implements.

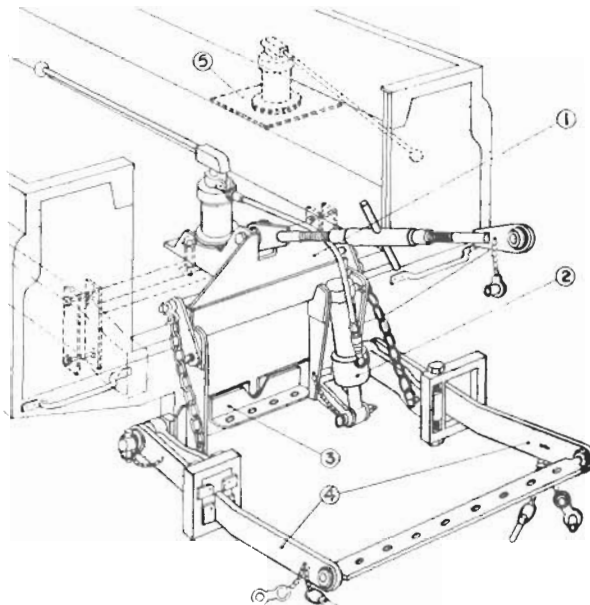

ARRANGEMENT OF PARTS

1. TOP LINK BRACKET & PUMP
2. CYLINDER
3. MAIN FRAME
4. DRAG LINKS
5. ALTERNATIVE PUMP POSITION

SHIPPING SPECIFICATIONS

Length	Width	Height	Volume	Nett Wt.	Gross Wt.
38 ins.	18 ins.	18 ins.	7.124 Cu. Ft.	252 lbs.	297 lbs.
96.5 centmrs.	46 centmrs.	46 centmrs.	0.44 Cu. Mtrs.	115 Kgs.	135 Kgs.

LAND-ROVER EXTRAS REQUIRED

In accordance with implement being operated.



▶ **“ALL-WORK” sawbench**

▶ **Power Arm with
No. 2 Mower**

▶ **Power Arm with
No. 3 Concrete Mixer**

As approved by the Rover Co. Ltd
for use with the

**LAND-
ROVER**

“ALL-WORK” Sawbench-fig. i

Cuts any length, anywhere. Cross cutting and ripping lengthwise, posts, firewood, rails, planking etc. Provides safe easy sliding table for cross cutting. Allows sawing on site, avoiding double handling. You just lower the Sawbench, adjust the jacks and get to work — when finished you raise it and drive off.

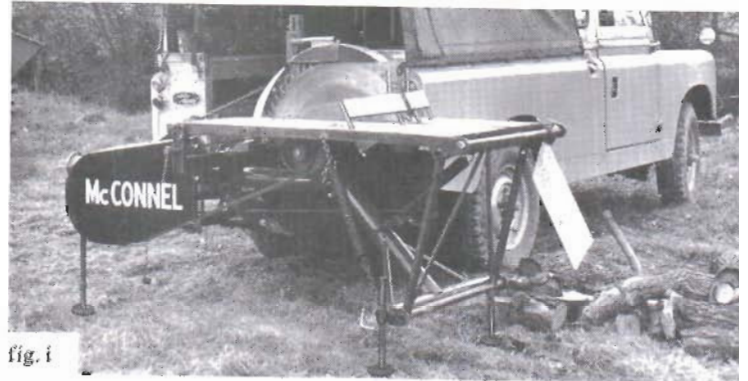

fig. i

POWER ARM

The Power Arm provides a common frame and drive onto which are plugged interchangeable heads each for a different job thus saving much duplication and expense.

The Armheads are attached to the arm by a single pin in a matter of minutes. They are raised hydraulically to lie behind the Land Rover for travel.



figs. ii

Armhead No. 2 Grass Mower-figs. ii

A superb 5 ft. cut, farm grass mower with every up-to-date refinement, now adapted for your Land Rover.

Armhead No. 3 Concrete Mixer-fig. iii

At last a Mixer which you fill at shovel height—not shoulder height. It is so much easier and your Land Rover takes it to wherever it is wanted.



fig. iii

Sole Manufacturers—

F. W. McCONNEL LIMITED
67 Chiltern Street, Baker Street, London, W.1.
Telephone: WELbeck 6462

CHANGE OF ADDRESS

71/73 Gt. Portland St.,
London, W.1.

Telephone: LAngham 2286

SPECIFICATION AND DETAILS

of the McCONNEL

- ▶ "ALL-WORK" Sawbench,
- ▶ Power Arm with No.2 Mower,
- ▶ Power Arm with No.3 Concrete Mixer.

GENERAL

These McConnell machines which have been giving satisfactory service on thousands of farms and practically every make of tractor with 3-point linkage for many years, can now be supplied with fittings for your Land Rover. An important advantage is that on occasions when you require your Land Rover for other work they can be used instead on most 3-point linkage tractors.

"ALL-WORK" Sawbench

It is fitted straight on to the Land Rover's 3-point linkage and coupled up to the rear p.t.o. shaft in a few minutes.

Specification: Saw blade 30" diam. Ball bearings. Working height adjusted by built-in jacks to suit operator. Roomy steel table top 31½" x 48". Log stops used for cross cutting with table sliding are removed for ripping lengthwise with table locked. Adjustable guide used for planking up to 12" from saw blade is rotated below table top for cross cutting. Saw guards (top and bottom) riving knife and safety belt release.

The "All-Work" is also available as "Armhead No. 4B" for plugging into the Power Arm at a saving in cost to Power Arm owners.

Power Arm

It is fitted onto the Land Rover's 3-point linkage by 3 pins and is coupled to the hydraulic system and rear p.t.o. in a few minutes.

Armhead No. 2 Mower (5' Cut)

It is plugged into the Power Arm and fitted by one pin. Safety release lets cutter bar fold back disengaging drive if obstruction is encountered.

Adjustment for tilt and lead of cutter bar is provided. Drive by vee belt and swing bar ensures the smoothest drive and longest life.

Armhead No. 3 Concrete Mixer

It is plugged into the Power Arm and fitted by one pin. Each mix takes 3 to 4 minutes including filling and emptying and gives a good barrow full of concrete as much as a man can wheel.

Height of drum is set by a prop to suit operator. Also invaluable for many other mixing jobs.

SHIPPING SPECIFICATION

Item	Measurements	Volume	Gross Wt.	Net Wt.
"All-Work" Sawbench 1 machine	5' 2" x 3' 1" x 2'	31.85 Cu. ft.	5 cwts.	4 cwts
5 machines	6' 3" x 6' x 3' 6"	136.5 Cu. ft.	24 cwts.	19½ cwts.
Power Arm with Armhead No. 2	6' 5" x 2' 4" x 1' 8"	25 Cu. ft.	5 cwts. 3 qr.	5 cwts
Power Arm with Armheads No. 2 and No. 3	6' 3" x 3' 4" x 2' 6"	52 Cu. ft.	9 cwts. 2 qr.	7 cwts.

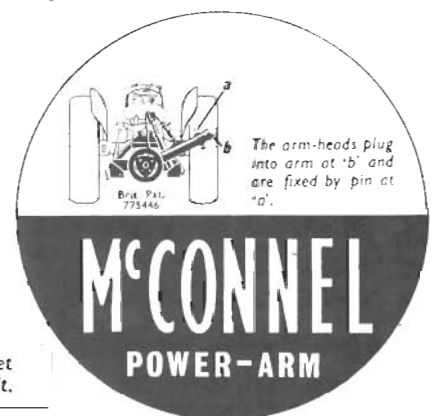

LAND ROVER EXTRAS REQUIRED :- Rear Power Take-Off.
Engine Speed Governor for Sawbench (Petrol Engine).
3-point Linkage as approved by the Rover Co. Ltd.

MITCHELL GRASS-CUTTING EQUIPMENT

As approved by the
ROVER CO. LTD
for use with the ...

**LAND-
ROVER**

Designed and built to stand the speed of mechanical Haulage, Dreadnought Gang Mowers have for many years been giving good service on Parks, Sports Grounds, Airfields, Golf



Courses and other large areas of grass in many parts of the world, and their reliability and low maintenance costs are well recognised. They are also proving of great value on Orchards and farm grass lands.

The units have a cutting width of 30-in. and are flexibly attached to the towing vehicle in gangs of 3 or 5, etc., and can be attached or removed without the use of tools. A wide range of adjustments is provided for the height of cut which can be varied from $\frac{1}{4}$ -in. to 4-in.

Maintenance is simple, as there are only four lubrication nipples and the drive mechanism is enclosed in an oil-retaining Gear Case.



DREADNOUGHT 5 and Land-Rover ready for action

The drive is taken from easily detachable Steel or Pneumatic-tyred land wheels, and transmitted through Machine Cut Hardened Steel Gears and Ratchet Clutches to the Cylinder Cutter; a complete train of Gears and Clutch is fitted to each side of the Mower, the Ratchet Clutches allowing Differential Action when turning. In addition, Levers are fitted to the Clutches to disengage the Drive to the Cutter for transportation purposes. The Gear Trains are completely enclosed in Aluminium Casings and operate in an oil bath.

Made by

F. MITCHELL (Nottm.) LTD., DERBY ROAD, NOTTINGHAM

Telephone: Nottm. 77701

Est. 1898

ENGLAND

SPECIFICATIONS AND DETAILS



Cylinder Cutters can be supplied either of 7-in. Diameter, fitted with 5 Blades, or 10-in. Diameter, fitted with 6 Blades and are mounted on Ball Bearings: the 7-in. Diameter Cutter will deal with grass up to 8 inches long. The 10-in. Cutter is desirable when cutting longer grass. The Cutter Cylinder is easily removable for re-grinding or replacement of blades. Exchange units are readily available.

The Bottom Blade Frame is a Steel fabrication, fitted with a simple and efficient method for setting the Cut; after setting, the Bottom Blade Frame is securely clamped to the Steel Side Frames and in conjunction with sturdy Cross-bars, ensures complete rigidity and entirely eliminates deflection when operating over hard and uneven surfaces.

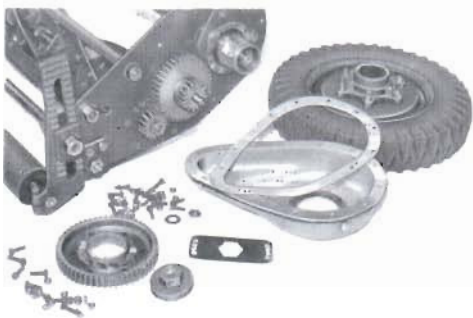

Dreadnought Unit with drive dismantled to show hardened Gears and Ratchet Clutches

Mower Units are 'ganged' as shown below—

DREADNOUGHT 3

DREADNOUGHT 5

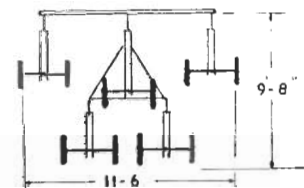
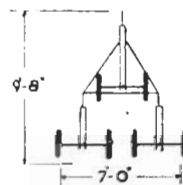

The Dreadnought 3 cutting 7' 0" wide, will cut approx. 5 acres per hour at 6 m.p.h.
 " 5 " 11' 6" " " " 8½ " " " "

Lever are fitted to each unit by which the cutting mechanism of the Mower can be lifted clear of the ground for crossing roads, etc. For more extended transportation it is arranged that units can be attached in line one behind another and winched on to trailer or lorry. This can be done by one man

SHIPPING DETAILS		Net Weight	Weight Packed in Wood Case	Dimensions of Case
Dreadnought 3	In 1 Case	918 lbs.	1332 lbs.	72" × 65" × 30"
Dreadnought 5	In 1 Case	1554 lbs.	2175 lbs.	126" × 65" × 30"

Land-Rover Extras Required: Towing Equipment (eight holed plate)

Made by

F. MITCHELL (Nottm.) LTD., DERBY ROAD, NOTTINGHAM ENGLAND

Telephone: Nottm. 77701

Est. 1898