

Land-Rover Service Newsletter Vol. 3 No. 3



January 1969

The Rover Company Limited Service Department: Solihull, Warwickshire, England

By Appointment to
Her Majesty
Queen Elizabeth II



Manufacturers
of Motor Cars and
Land-Rovers

NOTE

Due to the small number of items for circulation, no Service News Letter will be issued in February 1969. Vol. 3, No. 4 will therefore be distributed in March 1969.

IMPORTANT

Items numbered 22, 23, 24, 26, 27 and 28 in this News Letter introduce a major change point on Bonneted and Forward Control Land-Rovers.

The serial number suffix changes for these modifications are as follows:

Unit	Models			
	Land-Rover Bonneted Control		Land-Rover Forward Control	
	Petrol 4 and 6 cylinder	Diesel	Petrol 4 and 6 cylinder	Diesel
Chassis	D to F*	E to F	B to C	B to C

* Suffix letter 'E' has not been used on chassis serial numbers for Petrol Bonneted Control vehicles.

Item 15 SUBJECT: ROVER WARRANTY (Policy Item)

MODELS: All Land-Rovers.

REMARKS: The Rover Company Limited have decided to revise the Warranty given to every owner of its goods. The revision consists primarily of adding a mileage limitation to the existing time period, and becomes effective on all new Land-Rovers licensed from the 1st January 1969 onwards, and is applicable in the United Kingdom and Overseas markets.

It is essential that Distributors and Dealers make sure that the new Warranty is known to all Sales and Service personnel within their Organisation and also to customers when they order new vehicles.

For full details please refer to our Circular Letters dated 11th November 1968 United Kingdom and 20th November 1968 Overseas.

Item 16 SUBJECT: CRANKSHAFT (Policy Item)

MODELS: Land-Rover Bonneted and Forward Control with 2¼ litre Diesel engine.

MODIFICATION: Withdrawal of re-ground 2¼ litre Diesel crankshafts from Service usage.

LITERATURE
AFFECTED:

The relevant part numbers have been deleted from the revised Land-Rover Series II and IIA Parts Catalogue, Part No. 605957. See Item 17 in this News Letter. Land-Rover Series IIA and IIB Forward Control Parts Catalogue, Part No. 4862, Page 95.

PART NUMBERS:

Crankshaft assembly, .010 in. US	1	525852
Crankshaft assembly, .020 in. US	1	525853
Crankshaft assembly, .030 in. US	1	525854
Crankshaft assembly, .040 in. US	1	525855

REMARKS:

Owing to the exacting requirements for the fillet radii on Diesel crankshafts, undersize crankshafts must not be fitted on 2¼ litre Diesel engines. Reground Diesel crankshafts can of course be used on 2¼ litre Petrol engines, and any stocks of the above undersized crankshafts must be used only on 2¼ litre Petrol engines. Distributors and Dealers are requested to amend their records accordingly and to ensure that all personnel concerned are fully aware of this policy.

Item 17 SUBJECT:

LAND-ROVER PARTS CATALOGUE

MODELS:

Land-Rover Bonneted Control.

PART NO.:

Parts Catalogue, Land-Rover Series II and IIA, Bonneted Control Models 1 605957

REMARKS:

United Kingdom Distributors, Dealers and Fleet Operators will have already received their free-of-charge allocation of the new Land-Rover Parts Catalogue, Part No. 605957. Despatch of this publication to Overseas Distributors and to those Overseas Dealers and Fleet Operators who are on our direct Mailing List, will be made during the course of the next few days. Will Overseas Distributors please ensure that their Dealers receive copies of the new book just as soon as possible. The new Parts Catalogue completely supersedes the earlier Catalogue, Part No. 4656, which should now be destroyed.

Item 18 SUBJECT:

FUEL SYSTEM

MODELS:

Bonneted and Forward Control with 2.6 litre 6 cylinder Petrol engine.

REMARKS:

Instances of carburettor flooding have been reported. Our investigations have shown that the flooding is caused by impurities in the petrol, which prevent the float chamber needle valve from closing. If necessary, an AC filter, (AC Part No. GF 124—USA manufacture, or FS 2—UK manufacture) can be fitted into the existing sediment bowl, pending the introduction of an improved petrol filter. See Fig. 1.

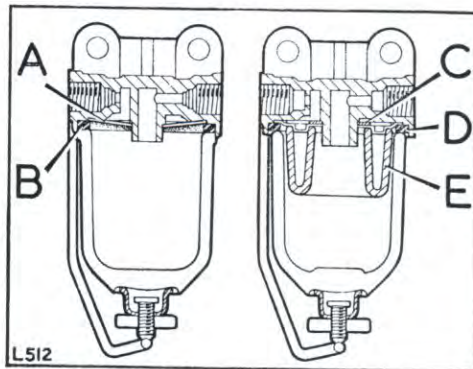

Fig. 1 Sediment bowl and filter

Remove original parts

A—Gauze filter B—Sealing washer

Replace with parts supplied in kit AC No. G.F. 124 or F.S. 2

C—Inner sealing washer D—Outer sealing washer E—Filter

The replacement period for this temporary AC filter is 4,000 miles (6,000 km). Supplies of AC filters should be obtained through normal trade sources.

Item 19 SUBJECT: CLUTCH

MODELS: Land-Rover Bonneted Control and Forward Control with 2¼ litre Diesel engine.

MODIFICATION: Introduction of additional identification feature for clutch driven plate with stronger centre.
See Land-Rover News Letter, Vol. 2, No. 32, Item 168.

REMARKS: During a subsequent spraying operation, the manufacturers are obliterating the colour code on the damper springs. It is therefore necessary to use the diameter of the centre for identification purposes.
See chart below.

Clutch driven plate		
	Part No. 561536 (early)	Part No. 571712 (late)
Diameter of centre, inside lining ..	6½ in. (155 mm)	6¾ in. (162 mm)

Item 20 SUBJECT: GEARBOX

MODELS: Land-Rover Bonneted and Forward Control.

MODIFICATION: Introduction of 'Caro-bronze' distance sleeve for mainshaft bush, to improve life of sleeve.

LITERATURE AFFECTED: All relevant part numbers are included in the revised Land-Rover Series II and IIA Parts Catalogue, Part No. 605957. See Item 17 in this News Letter.
Land-Rover Forward Control Parts Catalogue, Series IIA and IIB, Part No. 4862, Page 137.

PART NUMBER: Distance sleeve for mainshaft 1 571218

IDENTIFICATION: The latest distance sleeve can be identified by the circular groove on the flange.

REMARKS: The 'Caro-bronze' distance sleeve is completely interchangeable with the copper lead bronze sleeve previously used, and will be supplied for all Service requirements when stocks of the early type distance sleeve are exhausted.

Item 21 SUBJECT: TRANSFER GEAR CHANGE

MODELS: Land-Rover Bonneted Control.

MODIFICATION: Introduction of a slightly cranked transfer gear change lever, to ensure adequate clearance between the lever and the new recirculating heater, when fitted. See also Item 27 in this News Letter.

PART NUMBERS: All relevant part numbers are included in the revised Land-Rover Series II and IIA Parts Catalogue, Part No. 605957. See Item 17 in this News Letter.

COMMENCING NUMBERS: The gearbox suffix letter remains unchanged, but all Bonneted Control models from chassis suffix letter 'F' onwards will be fitted with the new transfer gear change lever.

REMARKS: When stocks of the early type transfer gear change levers are exhausted, the modified type will be supplied for all Service replacements.

Item 22 SUBJECT: BRAKES

MODELS: Land-Rover Bonneted and Forward Control.

MODIFICATION: Introduction of mechanical stop light switch, replacing the hydraulic switch, to provide improved reliability.

The brake pedal and mounting bracket have also been modified to suit, and a stronger spring ensures that the brake pedal returns fully and operates the mechanical stop light switch to the 'off' position.

On 109 Bonneted Control with 4 cylinder engine the 'CB' type brake master cylinder has been replaced by a 'CV' type.

PART NUMBERS: All relevant part numbers are included in the revised Land-Rover Series II and IIA Parts Catalogue, Part No. 605957. See Item 17 in this News Letter.

COMMENCING NUMBERS:

Suffix letter change:

Bonneted Control vehicles from chassis serial number suffix letter 'F' onwards.

Forward Control vehicles from chassis serial number suffix letter 'C' onwards.

REMARKS: Early and late parts are not interchangeable and both types must be stocked for all Service replacements.

Workshop information dealing with the above modification will be included in the new Land-Rover Workshop Manual which is currently being prepared.

Item 23 SUBJECT: ELECTRICAL HARNESS

MODELS: Land-Rover Bonneted and Forward Control.

MODIFICATION: Introduction of revised electrical harness to accommodate the mechanical stop light switch, centralised position of headlamp dip cables, waterproof snap connectors and permanent magnet type wiper motor.

See also Items 22 and 24 in this News Letter.

PART NUMBERS: All relevant part numbers are included in the revised Land-Rover Series II and IIA Parts Catalogue, Part No. 605957. See Item 17 in this News Letter.

COMMENCING NUMBERS:

Suffix letter change:

Bonneted Control vehicles from chassis suffix letter 'F' onwards.

Forward Control vehicles from chassis suffix letter 'C' onwards.

REMARKS: Early and late type electrical harnesses are not interchangeable and both types must be stocked for all Service replacements.

Item 24 SUBJECT: WINDSCREEN WIPER

MODELS: Land-Rover Bonneted and Forward Control.

MODIFICATION: Introduction of permanent magnet type windscreen wiper motor and improved rack tube, to provide quieter running.

PART NUMBERS: All relevant part numbers are included in the revised Land-Rover Series II and IIA Parts Catalogue, Part No. 605957. See Item 17 in this News Letter.

COMMENCING NUMBERS:

Suffix letter change:

Bonneted Control vehicles from chassis serial number suffix letter 'F' onwards.

Forward Control vehicles from chassis serial number suffix letter 'C' onwards.

REMARKS: Early and late windscreen motors are not interchangeable and both types must be stocked for all Service replacements.
 On the other hand, the improved rack tube and wheel boxes are completely interchangeable, and only the latest parts will eventually be supplied for all Service replacements.
 The appropriate Workshop information will be included with the new Land-Rover Workshop Manual, Part No. 606004, which is currently being prepared.

Item 25 SUBJECT: ALTERNATOR

MODELS: Land-Rover Bonneted Control with 4 cylinder engine and all Forward Control.
 MODIFICATION: Introduction of Lucas 11 AC alternator and split charge facilities replacing the Prestolite equipment previously used.
 This type of alternator is already available for the 6 cylinder 109 Bonneted Control Land-Rover.

LITERATURE AFFECTED: Land-Rover Optional Equipment Parts Catalogue, Part No. 605159, Page 41.

PART NUMBERS:	Alternator complete assembly .. 1	605947	Series IIA Bonneted Control models with 2¼ litre Petrol engine	} E1480
	Alternator complete assembly .. 1	605949	Series IIA Bonneted Control models with 2¼ litre Petrol engine	} E1481
	Alternator complete assembly .. 1	606026	110 Forward Control models with 2¼ litre Petrol engine	} E1492
	Alternator complete assembly .. 1	606028	110 Forward Control models with 2¼ litre Diesel engine	} E1493
	Alternator complete assembly .. 1	605746	110 Forward Control models with 2.6 litre 6 cylinder engine	} E1489
	Auxiliary battery charging kit for Lucas 11 AC alternator .. 1	605951	Series IIA 88 2¼ litre Petrol and Diesel, 88 2¼ litre Station Wagon Petrol and Diesel, 109 2¼ litre Petrol and Diesel, RHStg except Station Wagon	} E1482 and E1483
	Auxiliary battery charging kit for Lucas 11 AC alternator .. 1	605952	Series IIA 88 2¼ litre Petrol and Diesel, 88 2¼ litre Petrol and Diesel Station Wagon, 109 2¼ litre Petrol and Diesel, LHStg except Station Wagon	} E1482 and E1483
	Auxiliary battery charging kit for Lucas 11 AC alternator .. 1	605953	Series IIA 109 2¼ litre Petrol and Diesel Station Wagon, RHStg	} E1484
	Auxiliary battery charging kit for Lucas 11 AC alternator .. 1	605954	Series IIA 109 2¼ litre Petrol and Diesel Station Wagon, LHStg	} E1484

Auxiliary battery charging kit for Lucas 11 AC alternator	1	605748	110 Forward Control 2¼ litre Petrol and Diesel, 2.6 litre 6 cylinder Petrol RHStg	} E1490
Auxiliary battery charging kit for Lucas 11 AC alternator	1	605749	110 Forward Control 2¼ litre Petrol and Diesel, 2.6 litre 6 cylinder Petrol LHStg	} E1490

REMARKS: Where a Lucas 11 AC alternator is required on a new vehicle, the appropriate 'E' number must be quoted on the New Vehicle Order.

Kits for the subsequent installation of alternators and split charge facilities into vehicles already in service are available from our Parts Department under the above Part Numbers.

Full Workshop information for the above equipment will be found in the revised Land-Rover Workshop Manual, Part No. 606004, which is in the course of preparation.

Item 26 SUBJECT: HAND THROTTLE

MODELS: Land-Rover Bonneted Control, Petrol and Diesel models.

MODIFICATION: Introduction of new hand throttle control situated on the passenger's side of the instrument panel, to accommodate the new rectangular recirculating heater. The new hand throttle works in a vertical plane instead of a horizontal one as previously. See also Item 27 in this News Letter.

LITERATURE AFFECTED: Land-Rover Optional Equipment Parts Catalogue, Part No. 605159, Page 73.

PART NUMBERS: Hand throttle complete assembly, RHStg	1	605991	Bonneted Control models 2¼ litre Petrol	} E1517
Hand throttle complete assembly, LHStg	1	605992	Bonneted control models 2¼ litre Petrol	} E1518
Hand throttle complete assembly, RHStg	1	605993	109 Bonneted Control models 2.6 litre 6 cylinder Petrol	} E1414
Hand throttle complete assembly, LHStg	1	605994	109 Bonneted Control models 2.6 litre 6 cylinder Petrol	} E1495

COMMENCING NUMBERS: Suffix letter change: Bonneted Control vehicles from chassis serial number suffix letter 'F' onwards.

REMARKS: Where a hand throttle is required on a new vehicle, the appropriate 'E' number must be quoted on the New Vehicle Order.

Kits for installation into vehicles already in service are available from our Parts Department under the above Part Numbers.

The hand throttle is a standard fitment on Diesel vehicles, as previously.

Item 27 SUBJECT: RECIRCULATING HEATER

MODELS: Land-Rover Bonneted and Forward Control.

MODIFICATION: Introduction of improved type recirculating heater.

LITERATURE

AFFECTED: Land-Rover Optional Equipment Parts Catalogue, Part No. 605159, Page 141.

PART NUMBERS:	Front heater unit complete with demister 1	320690	2¼ litre Petrol and Diesel Bonneted Control	} E1513
	Front heater unit complete with demister 1	320692	109 Bonneted Control with 2.6 litre 6 cylinder engine	} E1516
	Front heater unit complete with demister 1	320694	110 Forward Control with 2¼ litre Petrol or Diesel engine	} E1514
	Front heater unit complete with demister 1	320696	110 Forward Control with 2.6 litre 6 cylinder engine	} E1515

COMMENCING NUMBERS:

Suffix letter change:
 Bonneted Control vehicles from chassis serial number suffix letter 'F' onwards.
 Forward Control vehicles from chassis serial number suffix letter 'C' onwards.

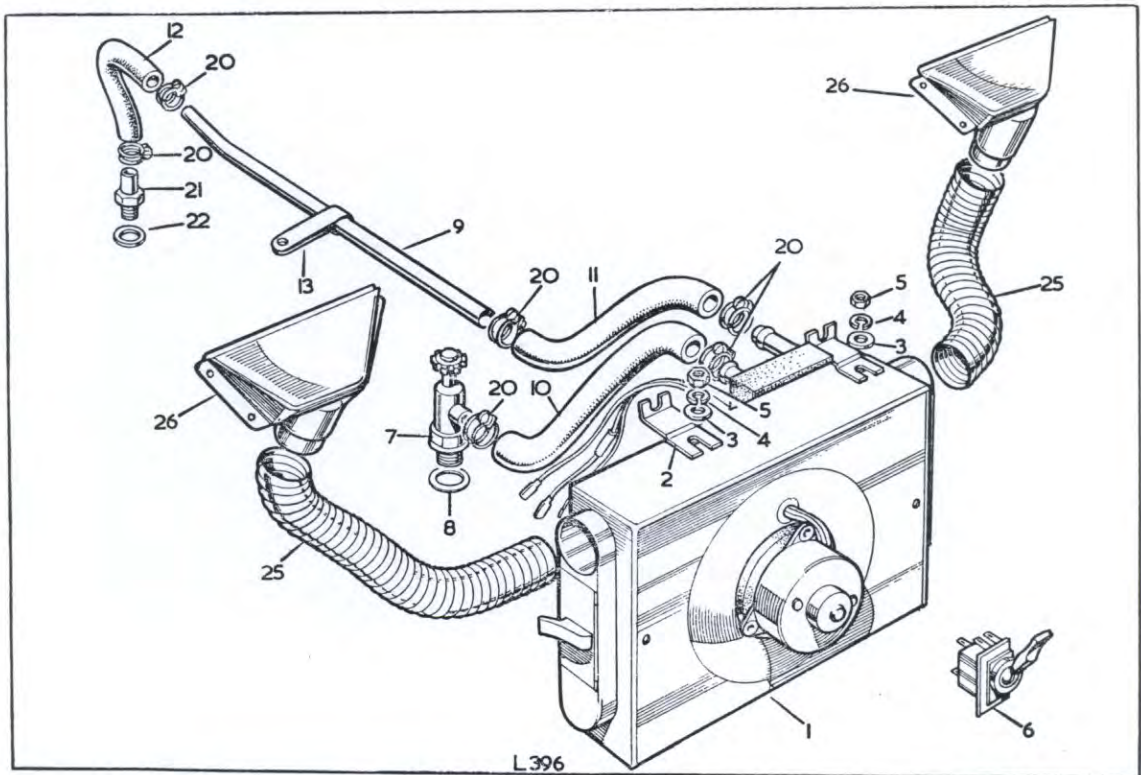

Fig. 2 Installation of recirculation heater, 4 cylinder models illustrated

- | | |
|-------------------------------------|--|
| 1 2-speed heater unit | 10 Inlet hose |
| 2 Bracket for heater unit | 11 Hose, outlet pipe to heater |
| 3 Plain washer | 12 Hose, outlet pipe to thermostat housing |
| 4 Spring washer | 13 Clip for outlet pipe |
| 5 Nut (¼ in. UNF) | 14 Clip for hose |
| 6 3-position switch for heater unit | 15 Adaptor for outlet pipe hose |
| 7 Valve for water control | 16 Joint washer for adaptor |
| 8 Joint washer for valve | 17 Corrugated flexible tube for demister |
| 9 Water outlet pipe | 18 Nozzle for demister |

INTERCHANGEABILITY: Early and late type recirculating heaters are not interchangeable and both types must be stocked to cover all Service requirements.

REMARKS: The new recirculating heater has an output of 3.5 KW at maximum fan speed, compared with 2.5 KW output of the early type.
 The new heater also has larger bore demister vents and a two-speed fan that is operated by a three-position switch on the fascia.
 Where a heater and demister is required on a new vehicle, the appropriate 'E' number must be quoted on the New Vehicle Order.
 Heater and demister kits for installation into vehicles already in service are available from our Parts Department under the Part Numbers listed on the previous page.
 For your information details of earlier Land-Rover Series II and IIA recirculation heaters are detailed below. It should be noted there is no interchangeability between any of the part numbers listed:

Bonneted Control

Heater, round type	1	330988	4 cylinder Petrol and Diesel up to chassis suffix 'C'
Heater, round type	1	320616	4 cylinder Petrol and Diesel chassis suffix 'D' to 'E' inclusive
Heater, oblong type	1	320663	6 cylinder Petrol up to chassis suffix 'E'

Forward Control

Heater, round type	1	320580	4 cylinder Petrol Series IIA
Heater, round type	1	320618	4 cylinder Petrol and Diesel Series IIB up to chassis suffix 'B'
Heater, round type	1	600391	6 cylinder Petrol Series IIA
Heater, round type	1	320620	6 cylinder Petrol Series IIB up to chassis suffix 'B'

Item 28 SUBJECT: DE-LUXE TRIM

MODELS: Land-Rover Bonneted and Forward Control.

MODIFICATION: Addition of anchor plate to De-Luxe trim assemblies for doors and floor, to accommodate the mechanical stop light switch. See also Item 22 in this News Letter.

LITERATURE AFFECTED: Land-Rover Optional Equipment Parts Catalogue, Part No. 605159, Page 167.

PART NUMBER: Anchor plate for brake return spring 1 240708

COMMENCING NUMBER: Suffix letter change:
 Bonneted Control vehicles from chassis serial number suffix letter 'F' onwards.
 Forward Control vehicles from chassis serial number suffix letter 'C' onwards.

REMARKS: When fitting the De-Luxe floor trim, it is necessary to remove the stop light switch protector plate from the pedal bracket, and replace it with the anchor plate, to ensure a good fit.